

TECHGLOBE Sp. z o.o.
12 Kolejowa Street, 23-200 Kraśnik, Poland
VAT Number.: PL9462697129



www.techglobe.pl

User manual

AUTOMATIC SCISSOR LIFT

V-SL-4000-PRO+



CE

March 2026

TABLE OF CONTENTS

1. General information.....	3
2. Technical data	5
3. Schematic diagram of the set.....	5
4. Preparing to start the lift	9
4.1. Connecting the power cable.....	9
5. Assembly and configuration instructions	15
5.1. Installation information.....	15
5.2. Lift operation – control panel	16
6. Storing the lift.....	17
7. Electrical diagram.....	18
8. Hydraulic diagram	19
9. Detailed view	20
Warranty Terms.....	21

1. General information

Before installing and using the device, please read this manual carefully and follow the instructions contained herein. All information contained in this manual is based on the latest technical data available for the product. The manufacturer reserves the right to change the product's specifications, packaging or the range of available products at any time and without notifying users. Due to the dynamic development of the product, there may be slight differences in design and/or description. The sketches, drawings and photographs contained in this manual are for illustrative purposes only.



Installation of the appliance must be carried out exclusively by a qualified person holding the appropriate certification. The installer is obliged to carry out the installation in accordance with the manual and the applicable regulations and standards concerning the safety of sanitary installations. Incorrect installation, repair or replacement of the appliance by unqualified persons may lead to permanent damage to the equipment or pose a risk to health or even life. When working with the appliance, observe all safety precautions indicated in the manual, on the stickers and labels affixed to the packaging and on the appliance.

The manufacturer accepts no liability for damage resulting from incorrect installation of the appliance, neglect of its technical condition, or use of the product contrary to its intended purpose. The user manual is an integral part of the set and must be kept in an accessible place for the entire duration of the appliance's use. Failure to follow the instructions contained herein may result in damage to the device, loss of the warranty, and the inability to make claims under the warranty.



Waste electrical and electronic equipment (WEEE) must not be disposed of with other household waste. Such equipment must be taken to a specialist WEEE collection point, such as municipal waste sorting centres (PSZOK), collection points run by electrical and electronic equipment retailers (e.g. when purchasing a new appliance) or another location designated by the local authorities.

Warning symbols

Symbol	Description
	Key information regarding life and health
	Key information regarding the appliance.
	Additional information regarding the operation of the device.

2. Technical data

Parameter	Value
Power supply	230 V (1-phase) 50/60 Hz
Power	2200 W
Lift weight	600 kg
Total weight	650 kg
Permissible ambient humidity	30–95% (non-condensing)
Lifting time:	30 s
Maximum lifting capacity	4000 kg
Maximum lifting height:	1200 mm
Minimum lifting height:	110 mm
Platform width:	530 mm
Length of platforms with ramps:	2250 mm
Platform length without ramps:	1550 mm
Clearance between ramps:	840 mm
Lift width:	1900 mm

3. Schematic diagram of the set

The unit is packed on a pallet and must be transported using a forklift.

Before unpacking and assembly, check the condition of the packaging. If the packaging is damaged, take photographs. Photographic evidence may facilitate any subsequent claims process.

After unpacking the kit, check its condition and completeness. If any components are missing, defects are found or other problems arise, please contact the seller. Due to continuous product development, there may be certain differences which do not significantly affect the operation of the device.

Lift dimensions

A	Platform length without ramps	1550mm
B	Lifting height	110–1200 mm
C	Lift base length	1550 mm
D	Platform width	530 mm
E	Clearance between ramps	840 mm
F	Lift width	1900 mm
G	Length of platforms with ramps	2250 mm

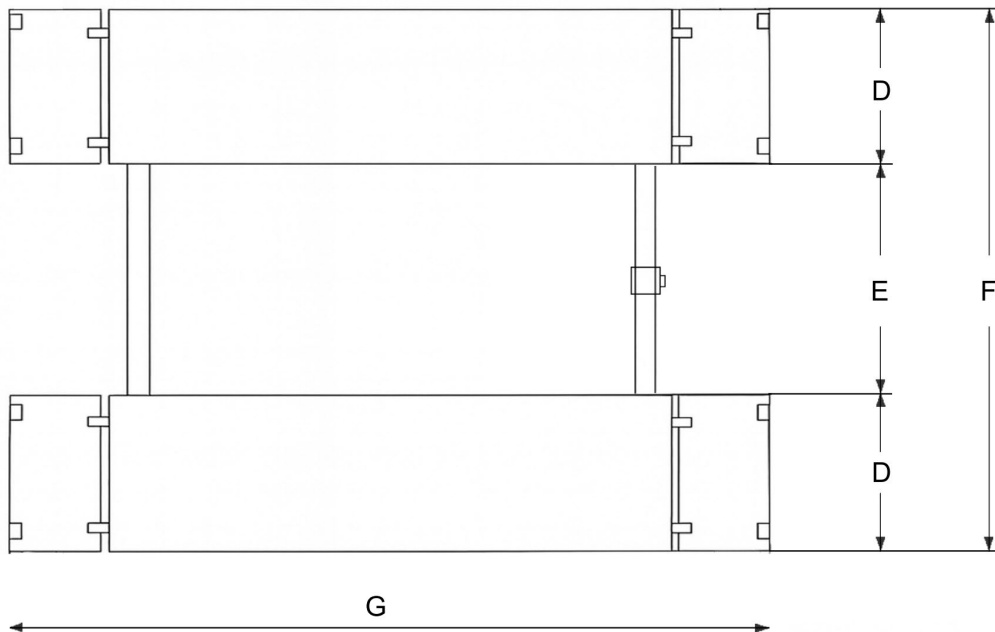
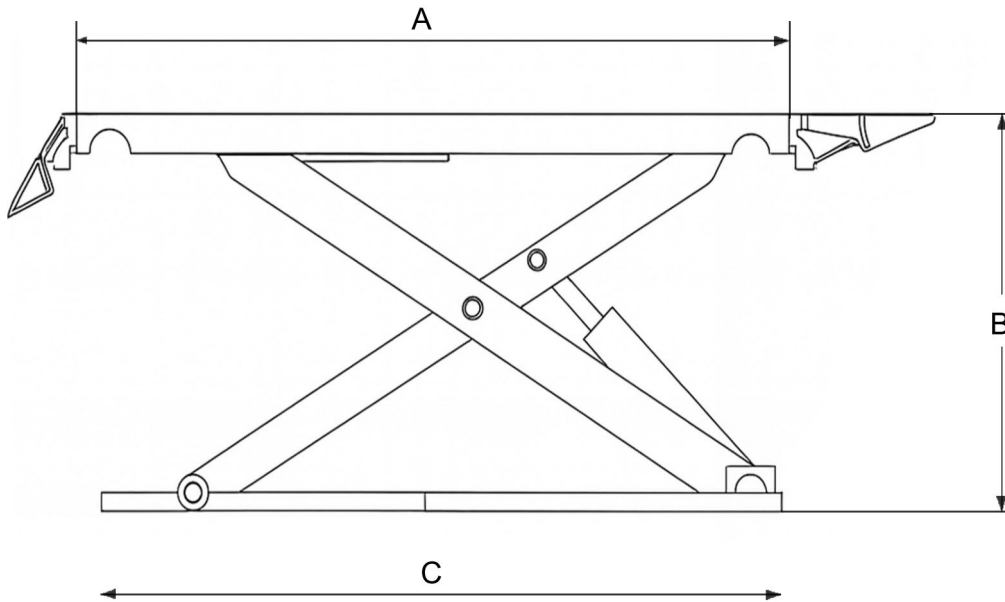

Description of lift components

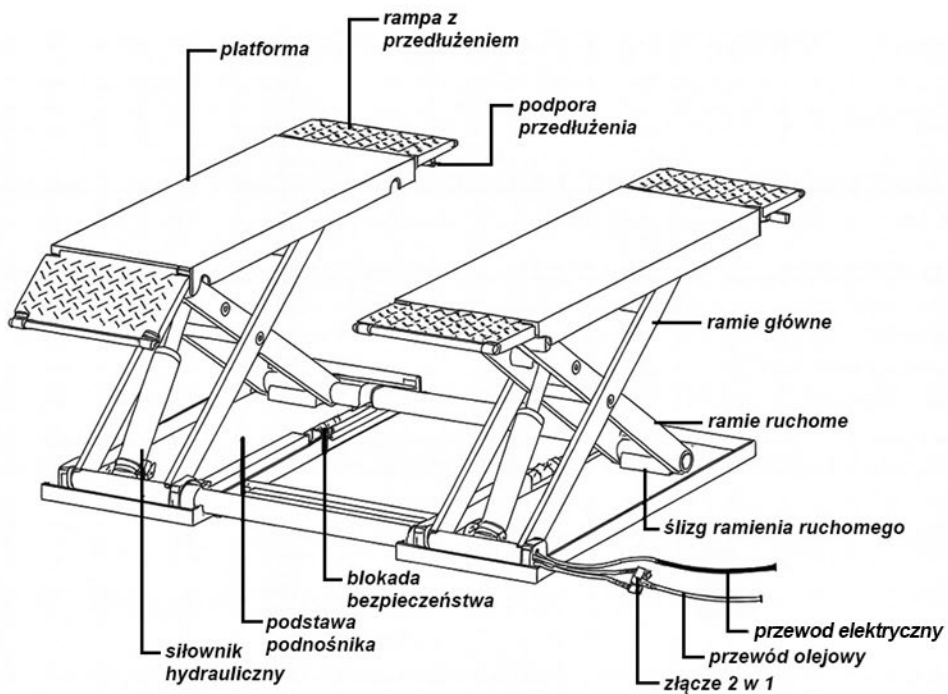

Do not leave any items in the vicinity of the locking mechanism.

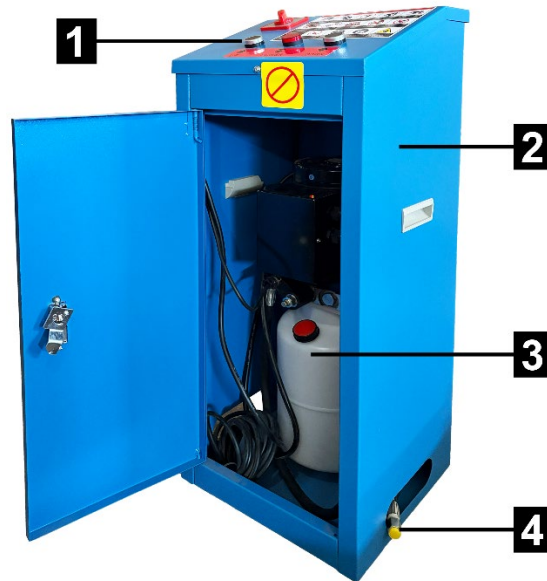

Cleaning with alkaline or acidic cleaning agents, petrol or solvents may damage the paintwork. Use neutral cleaning agents.

Control unit

- 1 Control panel
- 2 Control unit housing
- 3 Oil tank
- 4 Cable outlets (AC power, hydraulic hose, control cable)

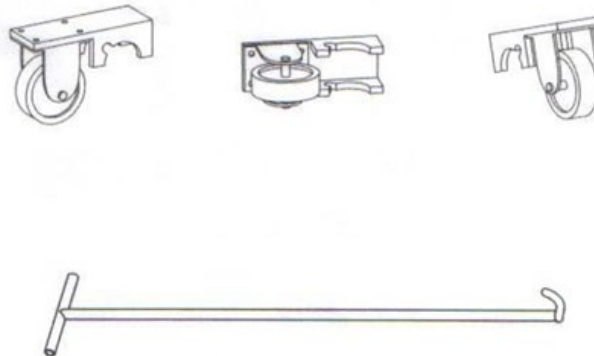
Transport wheels with a lever for moving the lift**Note!**

The above diagrams show only the main components. Further details are shown in the assembly drawing.

4. Preparing to start the lift

4.1. Connecting the power cable

1. Unscrew the screw at the front of the control unit and peel off the top of the sticker.

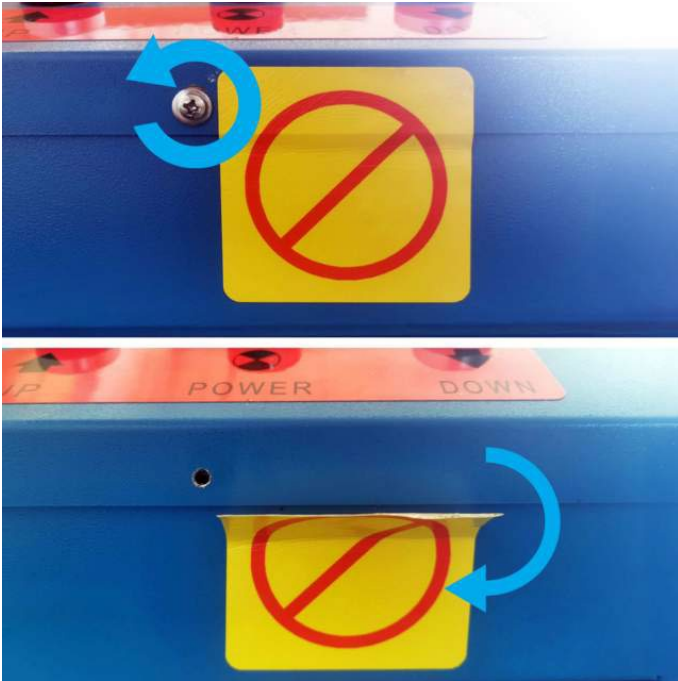

2. Open the control panel (by lifting it upwards)

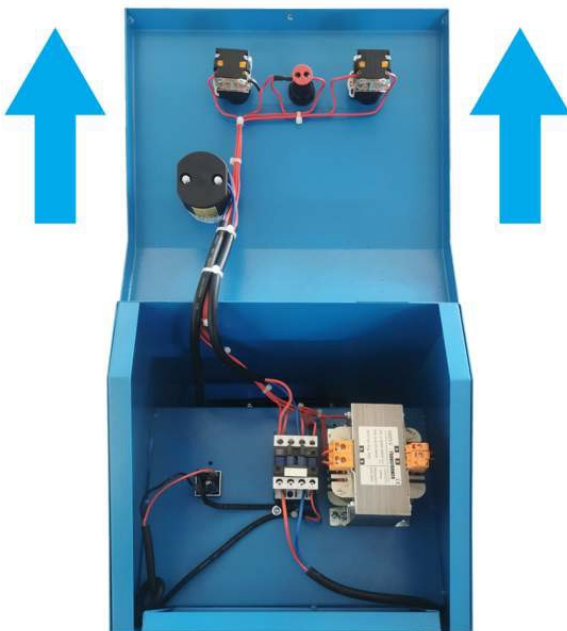

3. Unclip the plastic cable ties holding the cables connected to the control panel.

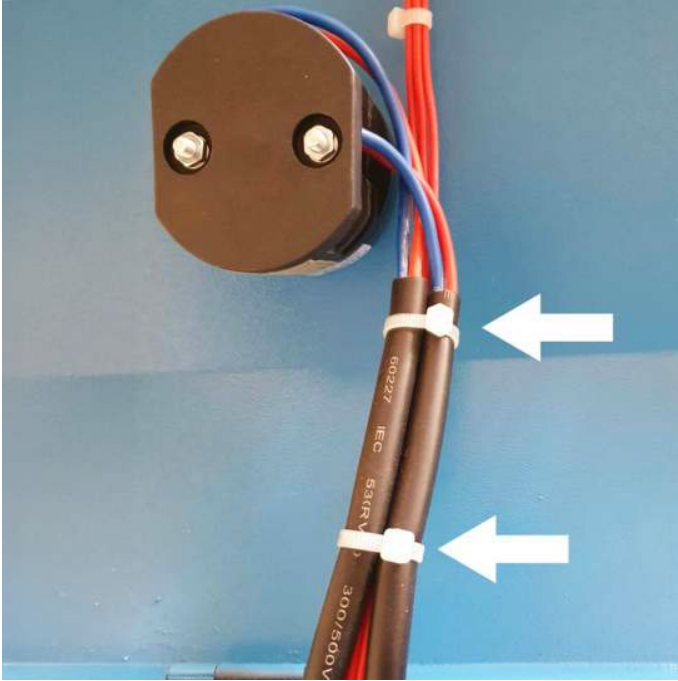

4. Loosen the screws securing the original power cable and remove the cables from the connectors.

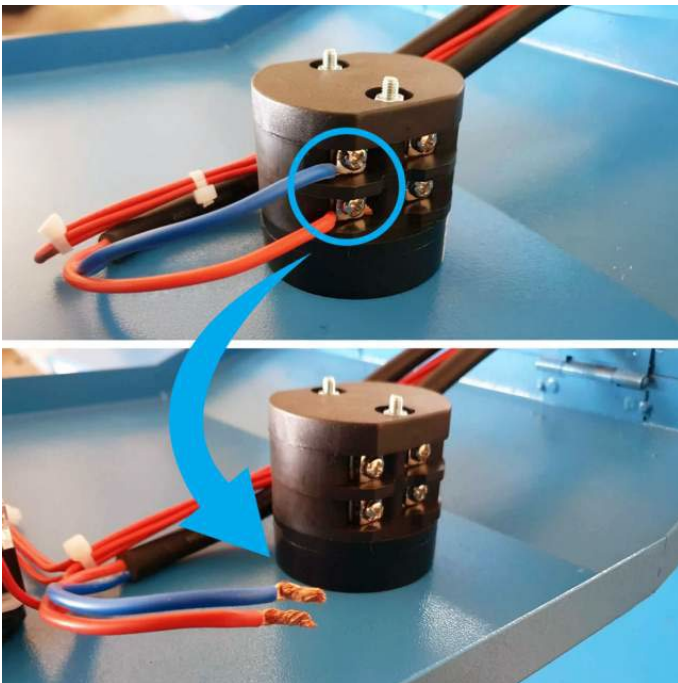

5. Route the new cable from the bottom of the control unit to the control panel. Insert the power cables in place of the old ones (brown and blue in place of red and blue). Tighten the screws. Secure the cables leading to the control panel together with plastic cable ties (as in step 3).

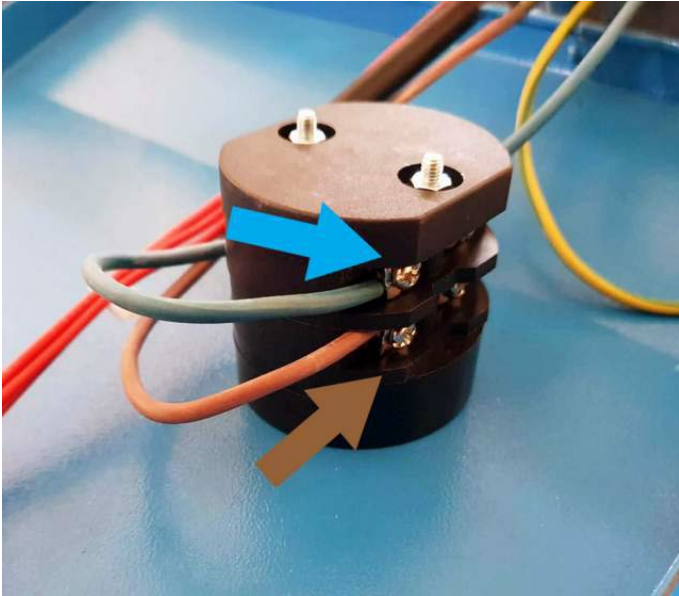

6. Attach the protective earth (PE – yellow-green) wire. The wire should be attached directly to the metal casing – not to the painted surface. It is possible to attach it to the base of the transformer (as shown in the diagram).

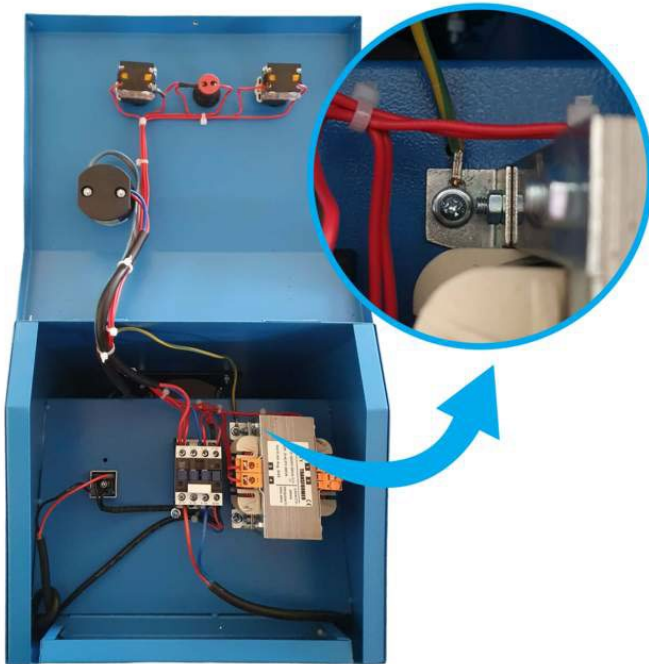

7. Close the control panel. Tighten the screw and stick the sticker back in its original place.



8. Final result



Connecting the hydraulic hose and control cable

Two hoses emerge from the control unit. (1) is the electrical cable, used to release the safety lock. (2) is the hydraulic oil hose, used for the hydraulic cylinders.

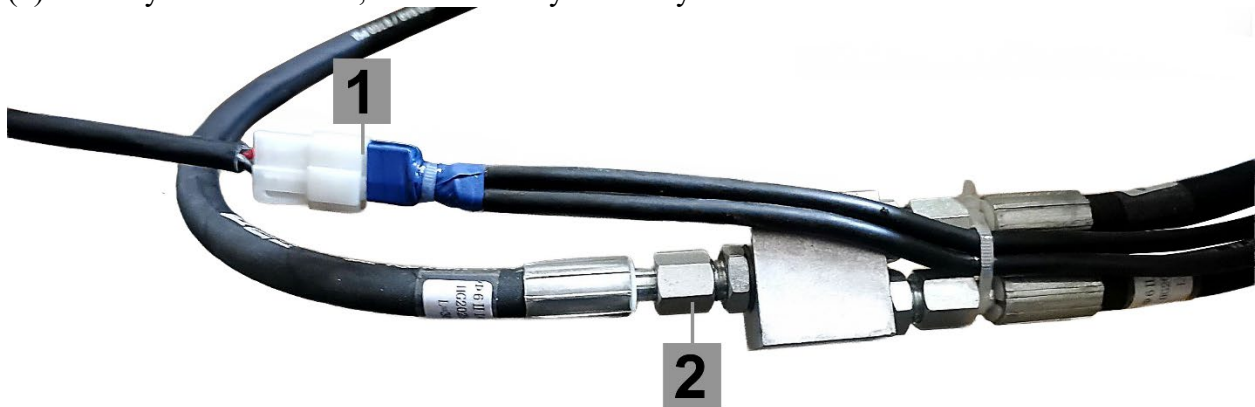

Filling with hydraulic oil

Open the door at the front of the control unit. Then unscrew the oil cap anti-clockwise to open the oil filler. Using a funnel, fill the reservoir with hydraulic oil via the oil filler shown in the diagram.



CAUTION

Use hydraulic oil only. Using any other type of oil may cause serious damage to internal

components, such as the oil pump, hoses and cylinders. **Recommended oil: HL46 or another type depending on operating conditions, e.g. HLP (HM) or HVLP (HV) grade oil. At least 5 litres of oil is required for start-up.**

- Ensure there is a sufficient amount of oil in the tank whilst the machine is in operation.
- Do not overfill the oil tank, as the oil may spill over during warm-up and expansion.
- Ensure that the oil tank cap is properly tightened before starting work.

5. Assembly and configuration instructions

5.1. Installation information

The lift should be installed in a safe location. The floor must not be cracked or uneven to ensure the lift is stable and can operate freely.

If the lift is installed outdoors, it must be protected from rain and wind.

	<p>WARNING! The device must not be used in an environment at risk of explosion.</p>
---	--

Recommendations regarding the installation site

The diagram shows the minimum recommended clearances from the lift to the walls. These clearances also correspond to the lift's working area. Persons other than specially trained and authorised operators are strictly prohibited from entering this area.

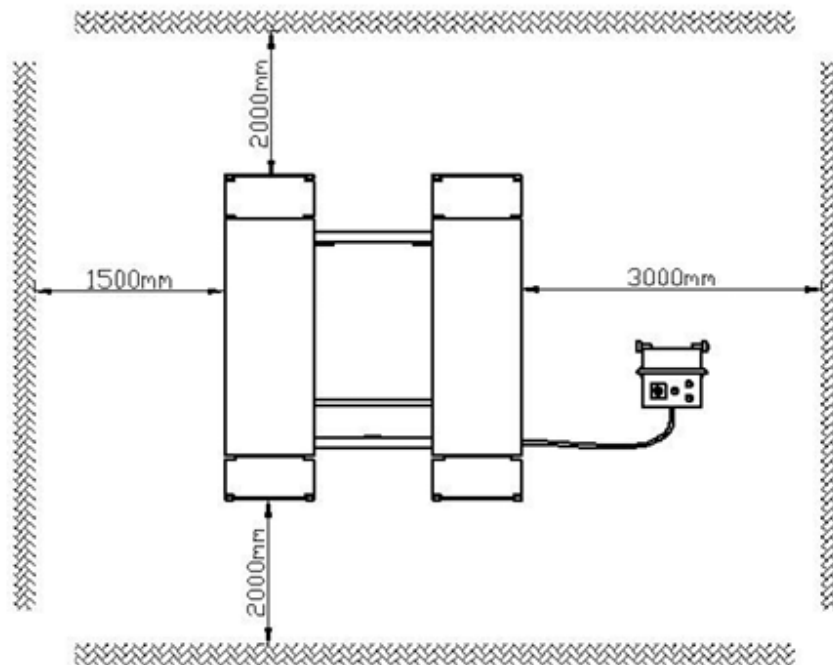

5.2. Lift operation – control panel



When using the lift, keep as far away as possible from its moving parts. No one must be under the lift or in the vehicle whilst it is in use. Maintain a safe distance. Failure to follow these rules may result in serious injury or death.

The control panel features a main power switch (0/1), 2 buttons and a power indicator.

UP – lift button

DOWN – lowering button + release button

POWER – power indicator



6. Storing the lift

If the device is to be stored for a prolonged period, you should:

- Lower the platforms and do not place any heavy objects on them.
- Disconnect the device from all power sources.
- Lubricate all parts that may be damaged if they dry out.
- Drain the hydraulic oil reservoir and wrap the machine in protective film to prevent dust from entering the internal mechanisms.

If the machine is to be restarted after prolonged storage, you should:

- Refill the oil in the reservoir.
- Reconnect the power supply.

7. Electrical diagram

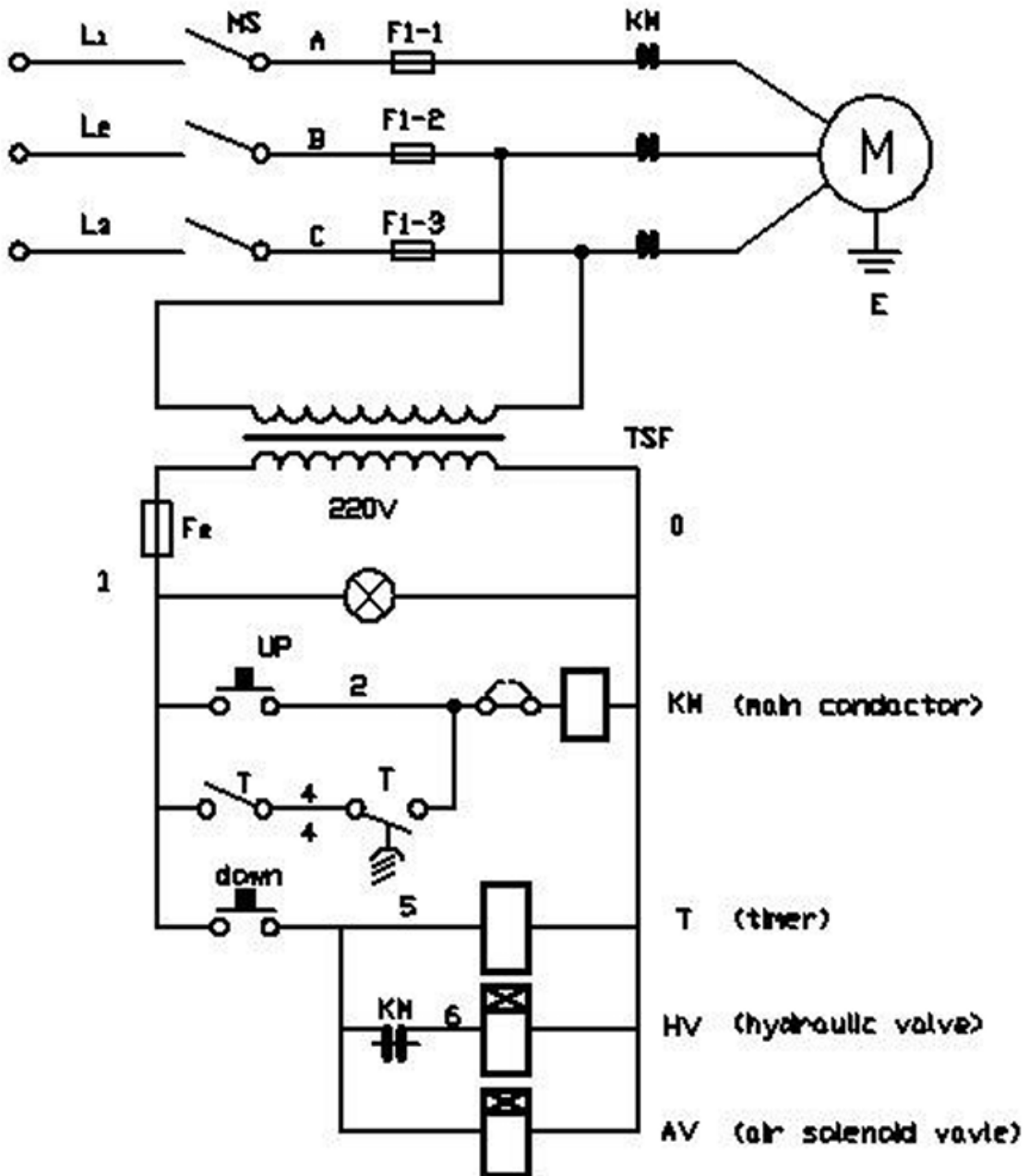

KM – main contractor – main contactor

T – timer – timer

HV – hydraulic valve

AV – air solenoid valve

8. Hydraulic diagram

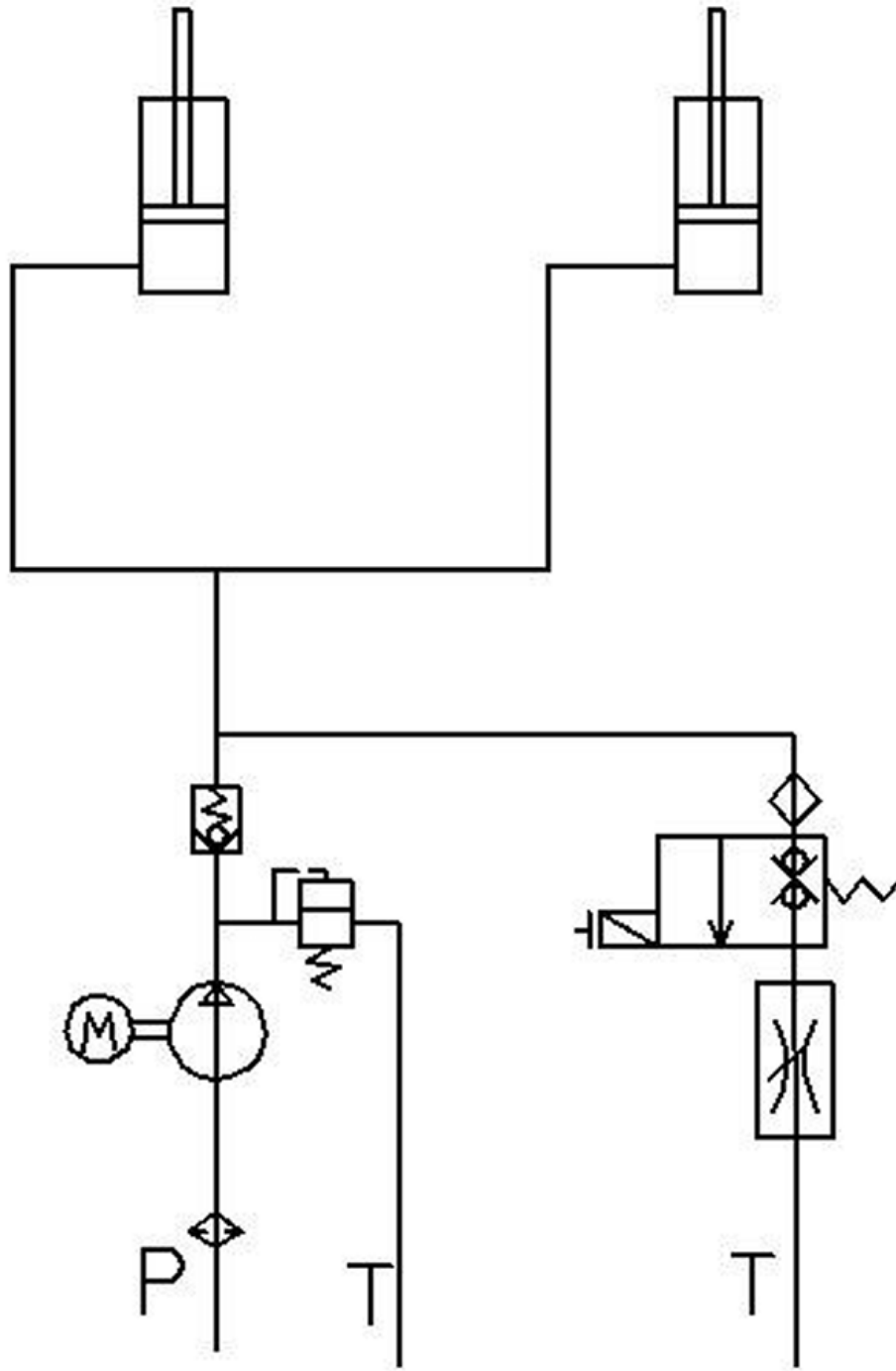

9. Detailed view

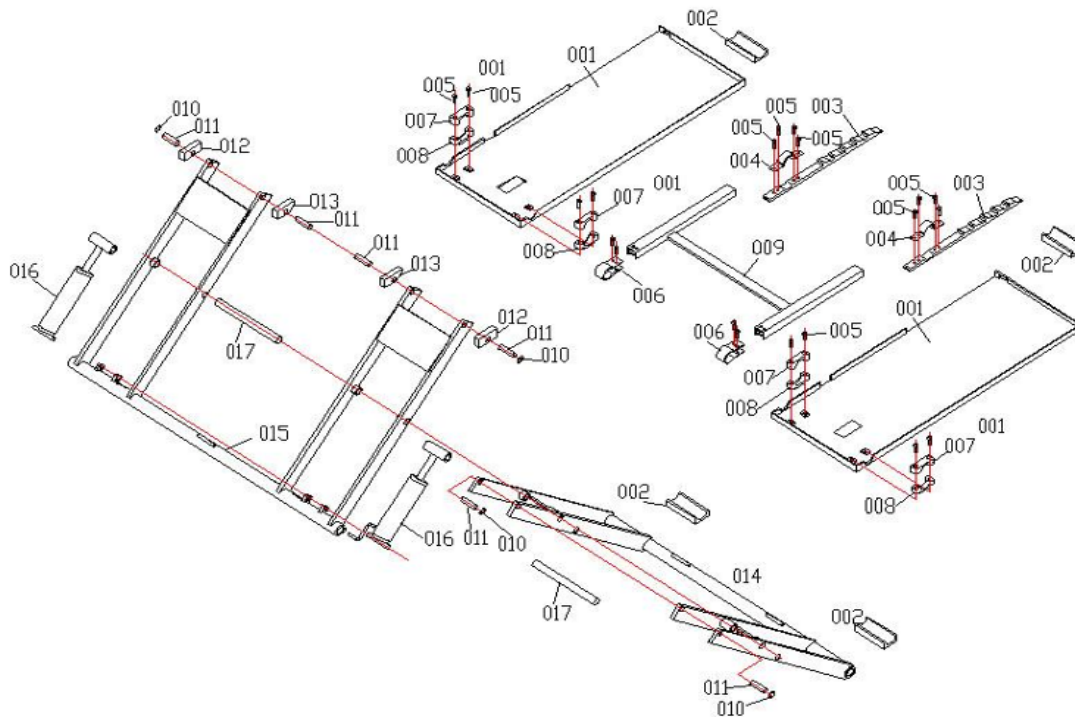

Serial number	Code	Name	Serial number	Code	Name
1	001	Base	11	011	shaft
2	002	sliding block	12	012	sliding block a
3	003	lock	13	013	sliding block b
4	004	locking clamp	14	014	drive arm
5	005	screw	15	015	driven arm
6	006	locking latch	16	016	hydraulic cylinder
7	007	upper block	17	017	shaft
8	008	lower block	18	018	ramp
9	009	lock cover	19	019	bracket
10	010	washer	20	020	platform

Warranty Terms

TECHGLOBE Sp. z o.o. grants the Purchaser a warranty for the Product offered in accordance with the following terms and conditions:

1. **TECHGLOBE Sp. z o.o.** provides a warranty valid for 24 months from the date of purchase.
2. The warranty covers manufacturing and material defects that become apparent during normal use.
3. During the warranty period, the defective product or its components will be repaired or replaced free of charge.
4. A proof of purchase must be presented to claim under the warranty.
5. The warranty does not cover:
 - mechanical damage,
 - damage resulting from improper use and/or installation,
 - normal wear and tear,
 - tampering by unauthorised persons,
 - damage caused by force majeure.
6. Warranty claims should be made in one of the following ways:
 - at the point of purchase,
 - by email to **bok@techglobe.pl**
 - by telephone on: **(+48) 510 510 945**
 - via the contact form on the techglobe.pl website
7. The repair period is up to 14 working days from the date the complaint is submitted. In exceptional cases, this period may be extended, particularly if spare parts need to be ordered or if specialist advice is required regarding the cause of the damage.
8. The warranty does not cover the right to claim compensation for lost profits arising from defects in the Product.
9. The Seller shall not be liable for any damage to persons or property that may be caused by a defect in the Product.
10. The Guarantor reserves the right to grant a one-off authorisation to a third party to replace parts and/or repair the Product. Such authorisation will be sent to the email address provided by the Purchaser.
11. If the Guarantor determines that the reported defect in the Product cannot be repaired at the Buyer's premises, the Product shall be repaired at the Guarantor's premises, and the Buyer may receive a replacement Product for the duration of the repair.